

Forward From Here

Stories, Updates, and Opportunities that Shape the Campaign for Bowdoin



Mills Hall (left) and the John and Lile Gibbons Center for Arctic Studies

The three years since *From Here: The Campaign for Bowdoin* publicly launched in February 2020, have been eventful, to say the least. The degree to which the Bowdoin community has supported each other and backed the College through unprecedented adversity and interruption has been nothing short of remarkable.

An impressive 70 percent of all alumni have participated in the campaign—by volunteering, attending an event, making a gift, or otherwise meaningfully engaging with the College. With gifts and pledges now over \$463 million, we enter a critical, late phase of the campaign, as we push toward our ambitious \$500 million goal.

Put simply, we are in the home stretch, and with the help of alumni, families, and friends, we hope to finish strongly. From its inception, this campaign has been focused on supporting current and future Bowdoin students in fundamental ways, through three bold promises: that any

student who earns a place here will have access to the full Bowdoin experience, regardless of their financial resources; that all Bowdoin students will receive a transformative education grounded in the liberal arts, innovative teaching, research, and scholarship, and the common good; and that every Bowdoin graduate will have the preparation and opportunity to land a great first job, en route to a meaningful career. We need your support for this historic effort, whether you are a frequent contributor or are considering your first gift. Please join us—BowdoinOne Day, detailed on the next page, is a great way to get involved.

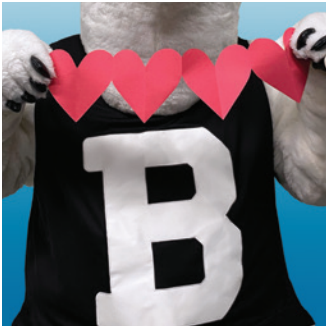

BowdoinOne Day is nearly here! On Thursday, February 16, we will again recognize National Acts of Kindness Day by coming together to celebrate kindness in our Polar Bear community. In addition to making your gift—of any size, to any designation—you can submit the name of someone from the Bowdoin community to receive a special act of kindness from the College. Three entries will be selected to receive a special surprise.



Good as GOLD

Above left:
Hanging the Class of 2020 banner at Thorne Hall

Above right:
Luis Miguel Guerrero '20, Cole Crawford '20, and Isabel Thomas '20

This past fall, an alumni couple passionate about supporting Bowdoin students issued a challenge to young alumni and senior students: if, during a single week in November, five hundred GOLD (graduates of the last decade) alumni and current seniors made gifts of any size to the Alumni Fund, the anonymous couple would give \$100,000 to financial aid at Bowdoin.

By the end of the week, young alumni and seniors had blown past the five-hundred-donor mark, with six hundred answering the rallying cry and unlocking the promised \$100,000 financial aid gift, as well as providing another \$15,770 in support for the College. The Class of 2020 proudly accounted for the most donors of any class—eighty-three—earning them the right to hang their class banner in Thorne Hall for the rest of the academic year.

With Planned Gifts, Trustee Emerita Shuman Supports Family and the College

In 2022, Bowdoin's Alumni Council honored trustee emerita D. Ellen Shuman '76 with the College's Alumni Service Award. The award citation described Shuman's legendary career as an institutional investor for colleges and foundations—she received the Investor Lifetime Achievement Award at Institutional Investor magazine's 2014 Investment Management Awards—but also described the ways she leveraged her investing acumen to benefit the College and fellow alumni, through investment advice, volunteerism, mentorship, and philanthropy.

Over the last two years, Shuman has established two significant planned gifts that, typical of her thoughtful approach to giving, benefit both her siblings and Bowdoin. Shuman's charitable gift annuity and charitable remainder trust will supplement the annual incomes of her brother and her sister, who have had successful but less lucrative careers, as a Grammy-winning blues musician and a nurse, respectively. Ultimately, both life income gifts will support the Paul H. Douglas Scholarship Fund. That fund, which Shuman established in 2006, provides financial aid to students who are committed to serving the common good.

"These structured gifts will enhance the quality of life for my siblings for many years while we are all alive together, and also support financial aid at Bowdoin. It's a win-win."



D. Ellen Shuman '76

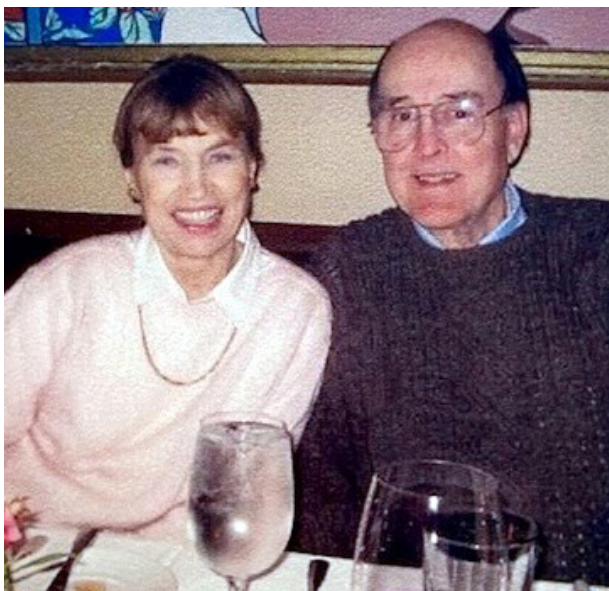

Norma and Roland Ware '54

Historic Ware Bequest Supports Professorship and Scholarship

Roland Ware '54, then an internal medicine physician, and Norma Leinonen Ware, a surgical nurse, met when scrubbing in together for surgery at Montreal General Hospital. The couple married in 1961, and after a stint in Massachusetts, moved back to Roland's native Maine, where he built a successful practice as a radiologist at Maine Medical Center. The pair shared many more interests than science and medicine, including a passion for travel and the outdoors and a devotion to educational opportunity and to supporting Bowdoin students and faculty.

During their lifetimes, Roland and Norma established both the Norma L. and Roland G. Ware Jr. Endowed Professorship and the Roland G. and Iva M. Ware Scholarship Fund. The professorship is earmarked for faculty members in the natural sciences, including chemistry or biology, while the scholarship provides aid to students from Roland's hometown of Rockland, Maine. Upon their passing in 2021 and 2022, respectively, Dr. and Mrs. Ware's joint estate provided one of the most substantial bequests in Bowdoin's history.



A Transformation for Pickard Fields

This summer, the College will transform the Pickard Fields complex with a set of significant upgrades to athletic fields, practice facilities, and spectator accommodations. With approval from environmental experts and local officials, installation of state-of-the-art playing surfaces, lighting, scoreboards, and seating will enhance the experience for Bowdoin athletes and fans.



Rendering of Pickard Fields upgrades

UPGRADES INCLUDE:

- a new **baseball field** (1) and **softball field** (2), each with synthetic turf, bullpens, batting cage, lighting, and sound; home and away dugouts; a 200-seat, accessible grandstand; press box; and scoreboard
- a new **rugby field** (3) with natural grass, lighting, and a sound system; a combined 200-seat accessible grandstand and press box; and scoreboard
- an upgraded **women's soccer field** (4) with existing natural grass and new lighting, sound system, and accessible pathway; and a new combined 200-seat accessible grandstand and press box
- a new **multipurpose field** (5) for varsity, club, and intramural sports, with synthetic turf, lighting, and scoreboard

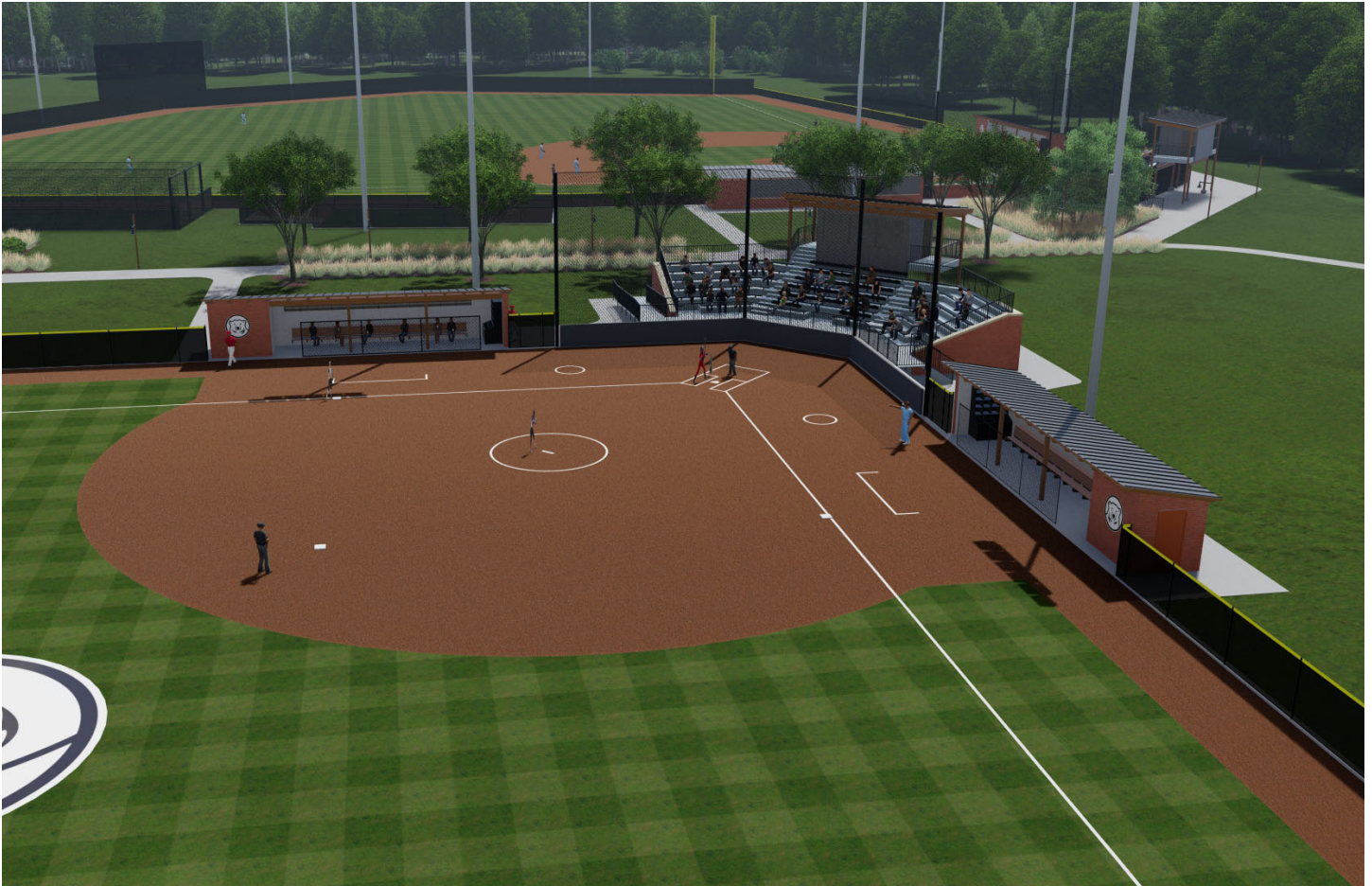

Rendering of softball field detail with grandstand and dugouts

The multimillion-dollar project will include long-needed upgrades that address safety and accessibility issues, by providing surfaces that better enable snow and ice removal—particularly important during the spring sports season—and ADA-compliant pedestrian walkways and seating. Additionally, low-impact, dark-sky-compliant lighting technology will make the playing fields usable for a larger number of students during longer periods of the day. These upgrades, along with improvements to the existing storm water treatment facility, will provide benefits to athletes, spectators, and the environment.

Donor recognition opportunities are available for many of these fields and facilities, including the existing men’s soccer field. To view a full listing of options, visit:

[Bowdo.in/pickardfields](https://bowdo.in/pickardfields)

For more information, contact Michael Archibald, vice president for development, at marchiba@bowdoin.edu or 207-725-3670, or your contact in the development and alumni relations office.



A student researcher on Kent Island checks on a storm-petrel chick.

Environmental Studies Is Having a Moment

Throughout this academic year, the College is marking the fiftieth anniversary of the environmental studies program with lectures, museum exhibitions, and academic symposia featuring alumni, students, and practitioners. For example, *Human Nature: Environmental Studies at 50*, an exhibition curated by five current students and one faculty member, will explore how twentieth-century artists depict humans' relationship to the environment. The exhibition opens in March and runs until June.

This golden anniversary comes at an extraordinary moment for Bowdoin's academic program. The interplay of four world-class facilities—the Roux Center for the Environment, the Schiller Coastal Studies Center, the Bowdoin Scientific Station on Kent

Island, and the nearly completed John and Lile Gibbons Center for Arctic Studies—are providing unprecedented opportunities for students, faculty, and collaborators from around the world to produce groundbreaking environmental research, scholarship, and teaching. Current topics include climate change and resilience, environmental justice, human and ecological impacts, food systems, and urban design, among many others.

This milestone also comes with an opportunity: Bowdoin alumni, families, and friends are invited to participate in the Doherty Challenge. A recent \$1 million award from the Henry L. and Grace Doherty Charitable Foundation, which supports a new postdoctoral scholar position at Kent Island, asks for a matching \$1 million from the College to support the position and the research and scholarship it will produce. For more information about how you can support this vital work, contact Liz Armstrong, senior associate director of gift planning, at larmstr@bowdoin.edu or (207) 798-4232.

Other New Endowed Funds

Since September 1

Elizabeth Ann Baird Scholarship Fund, provides financial aid for Bowdoin students majoring in art history or visual arts, established by David B. Humphrey '61.

James H. Baird Jr. Scholarship Fund, will provide financial aid for Bowdoin students who are from Delaware or are interested in government or economics, established by Jeffery D. Begin '73, P'05 and Joseph F. Bonasera '73, P'98, P'99, in memory of James H. Baird Jr. '73, P'00, P'02.

Paul '59 and Gisela Estes Scholarship Fund, provides financial aid for Bowdoin students from New Hampshire, established by Gisela B. Estes W'59.

Ben Hill-Lam '13 Memorial Scholarship Fund, provides financial aid for Bowdoin students, established by Seeyan Lam P'13 in memory of his son, Ben Hill-Lam '13.

Ben Hill-Lam '13 Physics Scholarship Fund, provides financial aid for Bowdoin students majoring in physics, established by Seeyan Lam P'13 in memory of his son, Ben Hill-Lam '13.

Kendall Family Scholarship Fund '89, '90, provides financial aid for Bowdoin students from Maine or Massachusetts, established by Richard L. Kendall Sr. '89, P'26 and Elizabeth Hale Kendall '90, P'26.



“These structured gifts will enhance the quality of life for my siblings for many years while we are all alive together, and also support financial aid at Bowdoin. It’s a win-win.”

—D. Ellen Shuman '76

For more information about *From Here: The Campaign for Bowdoin*, visit bowdoin.edu/fromhere.

From here.



Bowdoin College
5700 College Station
Brunswick, Maine 04011-8448

Bowdoin